

duo.
Image Carrier

designed by duo

hello.xpress

The new generation case-to-counter

5 good reasons to choose **hello.xpress**



- **hello.xpress**

1 case
1 counter
2 xpressions 3x1

1. A smart solution : a case which converts into a counter and holds two structures
2. A tool that allows you to meet customers wherever they are : trade fairs, conferences, exhibitions, sales points or workplaces
3. An « all-in-one solution » offering a case with a display area, a presentation counter and storage space
4. The case requires minimal logistical organization (no extra packaging, no tools and easy handling)
5. Ideal for hassle-free travel by plane or train.

Choose the **hello.** most suited to your needs

hello.counter **xpress**

counter case H 890 mm,
counter top 927 mm x 453 mm

hello.xpress

counter case containing 2 **xpressions.3x1**
H 2380 mm x 790 mm with 2 shelves.



hello.xpress applications



hello.xpress is a case that turns into a counter and contains 2 structures.

Optimize the impact of your message with its unique , innovative design

Functional : ergonomic shelving system

Enhance your visibility on the ground

Update and develop your message with ease, changing the graphic is child's play

hello.xpress applications



hello.xpress

graphics positioned on two separate planes to create a dynamic effect

Intense colours, realistic details and unbeatable colourfast properties

A 3D solution giving real depth to your message.

hello.xpress applications



hello.xpress

the fabric pannels can be individually replaced to display a new message

Simple and quick set up and pack away

No need to take the graphics off during storage

hello.xpress sample configurations

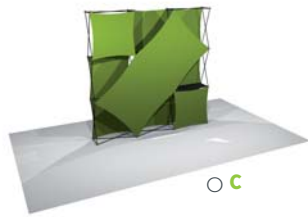

Change and develop your message to suit your needs !



* this configuration uses more shelves than are actually contained in the hello.xpress

Your **hello.xpress** in detail



Ultra light recycled aluminium frame

Powerful magnetic connectors allowing the frame to open automatically

« buttoning » fixation system

Adjustable stabilizing feet

Trolley for ease of transport

Rotomoulded, shock-resistant case.



xpress

Your **hello.counter** in detail



*The pictured model is sold in grain textured black only

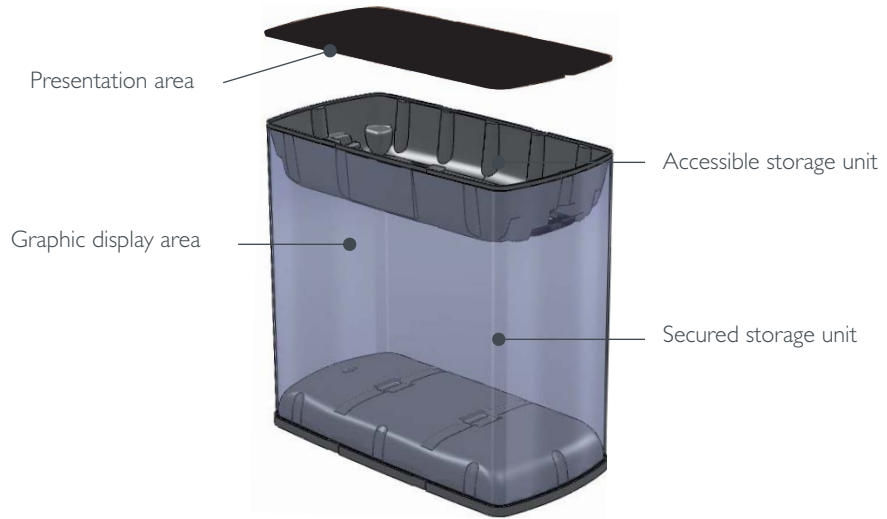

hello.xpress accessories



>Shelves



>Adjustable feet



>Stabilizers



>150 W spotlights

Technical specifications

	hello.counter ^{xpress}	structures hello.xpress
Set up	2 minutes	less than a minute
Width	927 mm	790 mm
height	890 mm	2380 mm
weight without graphic	13 Kg	2 Kg
further information	case in ABS wrap in polypropylene aluminium slider bars (850 mm de H)	Aluminium frame

Set up instructions, videos and printing templates can be downloaded from our website www.duodisplay.com

Our commitments

Today, commitment to the environment has to be more than just an idea. It must be translated into practical measures ! That is why our Research and Development team strive to design products that are as ergonomic as possible whilst minimizing the quantity of materials used.

By working to reduce the weight of our products, duo. is also reducing the environmental impact of their transportation.

Optimizing the weight and volume of our products not only benefits the customer but also minimizes their environmental footprint throughout their lifecycle (less cardboard, less adhesive tape, less fuel, less storage space...)

Our products are manufactured using recycled aluminium and we work hand in hand with our suppliers to limit waste.

The duo.recycling programme reuses products which have reached the end of their lifecycle.

We now recommend covering our structures with fabrics made from recycled fibers and printed with dye sublimation inks (a printing process using water based inks, containing 80% water).

Today, duo.'s approach is based on a simple idea : offering irresistible eco-friendly products !



duo.

Image Carrier

France	+ 33 4 99 63 2050
Canada	+1 514 934 0606
U.S.A.	+1 312 421 7755

www.duodisplay.com

344, rue Jardin Colar - 34130 Lansargues - FRANCE